

SCALE
 1:1200 METRIC
 1" = 100' ENGLISH

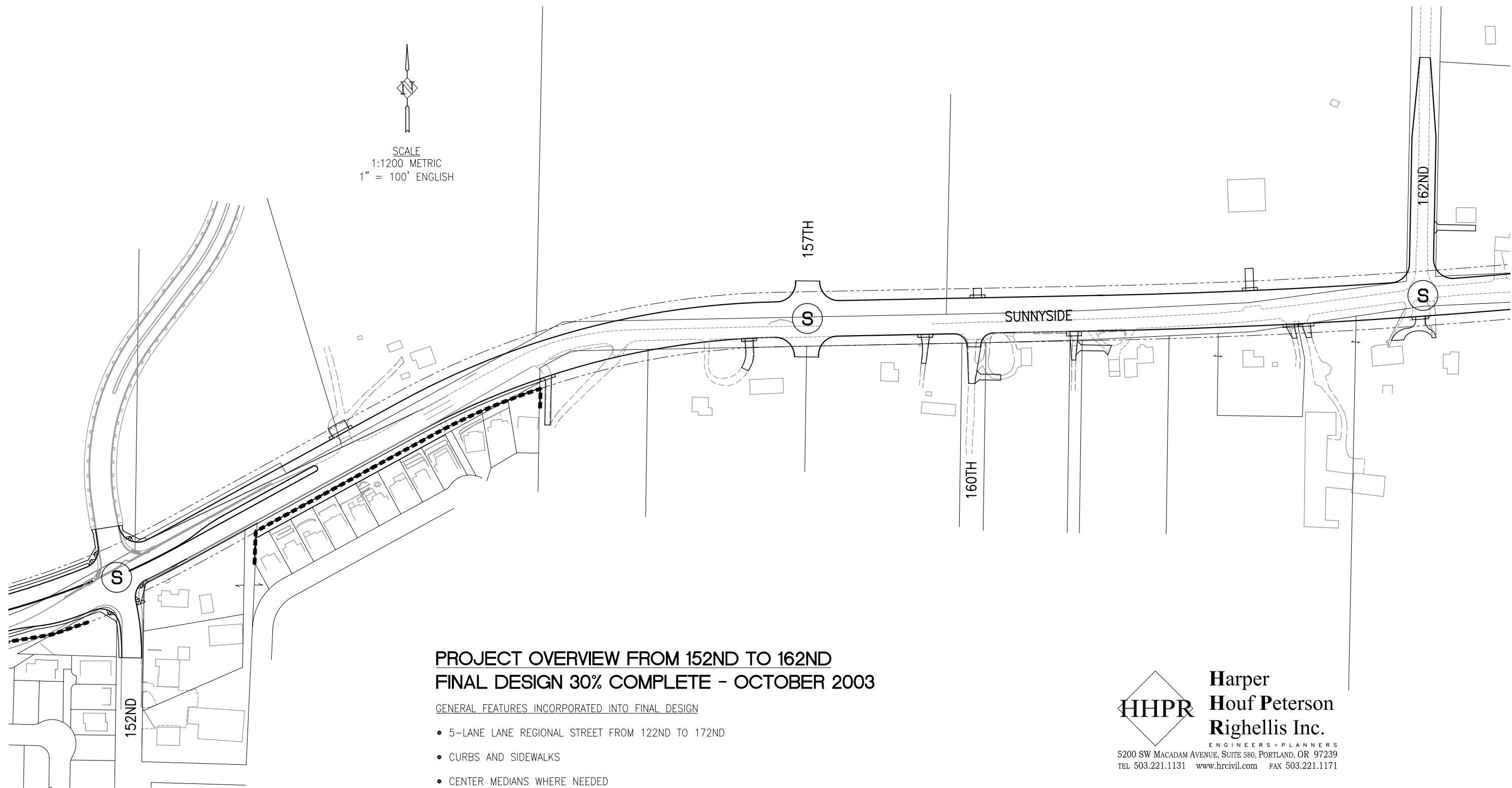



**PROJECT OVERVIEW FROM 152ND TO 162ND
 FINAL DESIGN 30% COMPLETE - OCTOBER 2003**

GENERAL FEATURES INCORPORATED INTO FINAL DESIGN

- 5-LANE REGIONAL STREET FROM 122ND TO 172ND
- CURBS AND SIDEWALKS
- CENTER MEDIANS WHERE NEEDED
- BIKE LANES
- TRAFFIC SIGNALS
- STREET LIGHTING
- LANDSCAPING
- SOUND WALLS AND RETAINING WALLS
- STORM DRAINAGE DETENTION AND WATER QUALITY TREATMENT FACILITIES

LEGEND

-  NEW OR MODIFIED TRAFFIC SIGNAL AT INTERSECTION
-  SOUNDWALL LOCATION



**Harper
 Houf Peterson
 Righellis Inc.**

ENGINEERS • PLANNERS
 5200 SW MACADAM AVENUE, SUITE 580, PORTLAND, OR 97239
 TEL 503.221.1131 www.hrcivil.com FAX 503.221.1171



Sunnyside Road Improvement Project

Phase IV: 152nd Avenue to 172nd Avenue